

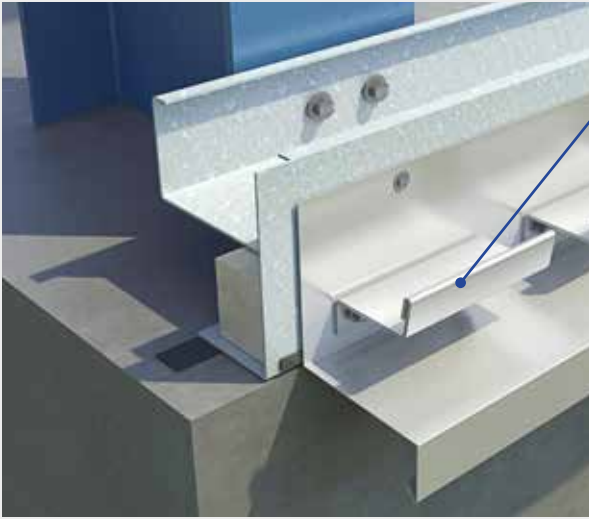

Insulated Wall Panel **Accessories**

INSULATED WALL PANEL ACCESSORIES



1 Panel Bearer

Panel bearers are fixed to a support angle at the base of the wall. These panel bearers support the first panel.

Panel bearers are fixed at 1500mm maximum centres, with a bearer 150mm from each panel end.

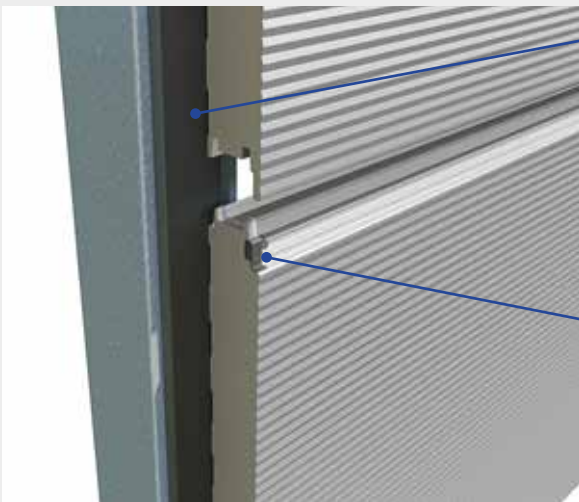

2 Bubble Gasket

An EPDM bubble gasket seal is applied to the panel joint rail at panel joints. This acts as an air seal at the junction.

The bubble gasket should run the full length of the panel joint rail, down to the drip flashing.

3 Foam Fillers

Foam fillers are inserted at each end of the joint in the panel fixing cavity. These are sealed with a run of clear silicone, which runs the full depth of the panel.



4 Top Hat Jointing Strip

A top hat flashing is fitted in front of the 40mm PIR insulation board in between the vertical joint of two horizontally laid ASMR wall panels. This top hat is fixed through to the panel joint rail, with a press in cover inserted to hide the fixings. The top hat will be fixed at a maximum 500mm centres. Before fixing the top hat a 6x5mm butyl seal must be applied to the face of each panel, 10–15mm from the panel edge.

INSULATED WALL PANEL ACCESSORIES

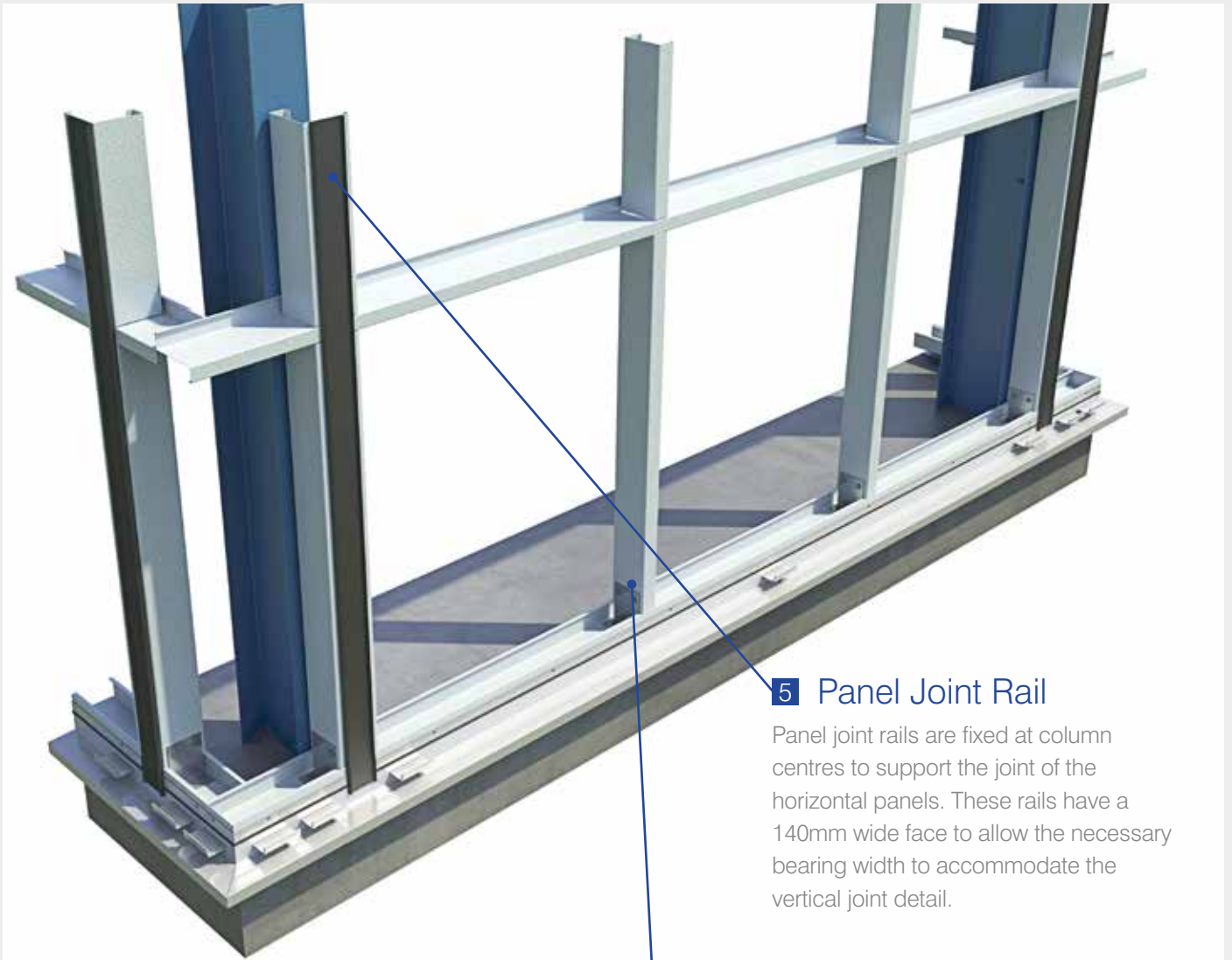

5 Panel Joint Rail

Panel joint rails are fixed at column centres to support the joint of the horizontal panels. These rails have a 140mm wide face to allow the necessary bearing width to accommodate the vertical joint detail.

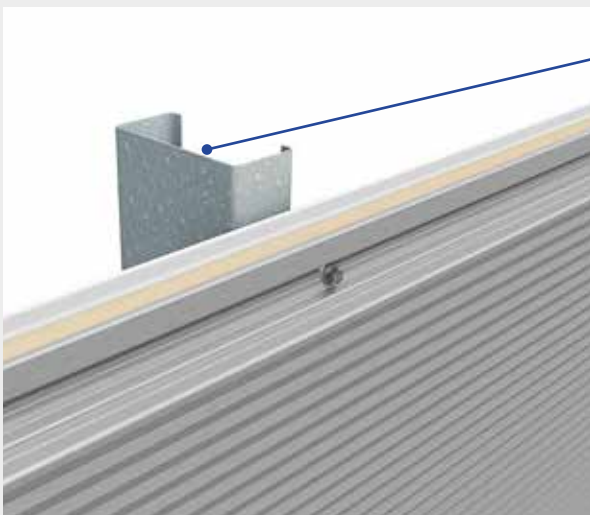

6 Intermediate Vertical Rails

A smaller intermediate rail (140mm deep cee section) with a minimum 50mm bearing is used to create a support at intermediate points. These rails will be fitted between the side rails. The panel will be fixed to these intermediate supports in the fixing cavity.

England & Wales

A Steadman & Son
Warnell
Welton
Carlisle
Cumbria
CA5 7HH

Tel: 016974 78277
Fax: 016974 78530

Scotland & Ireland

A Steadman & Son
Unit C
Coalburn Road
Fallside Ind Est
Bothwell
G71 8DA

Tel: 01698 819 050
Fax: 01698 801 764



E-mail: info@steadmans.co.uk
Online: www.steadmans.co.uk



©SIG Trading Limited

The information given in this guide shall be regarded as accurate at the time of going to print and may be subject to change thereafter.

A Steadman & Son (a trading division of SIG Trading Limited) reserves the right to alter or delete any product and/or technical specification featured in this guide without prior notice.

If in any doubt please contact info@steadmans.co.uk